

Features

- High isolation 5000 VRMS
- DC input with transistor output
- Operating temperature range - 40 °C to 110 °C
- REACH compliance
- Halogen free
- MSL class 1
- Regulatory Approvals
 - UL - UL1577
 - VDE - EN60747-5-5(VDE0884-5)
 - CQC - GB4943.1

Applications

- Switch mode power supplies
- Programmable controllers
- Household appliances
- Office equipment



Description

The ICPL-851 series combine an AlGaAs infrared emitting diode as the emitter which is optically coupled to a silicon planar high voltage phototransistor detector in a plastic DIP4 package with different lead forming options.

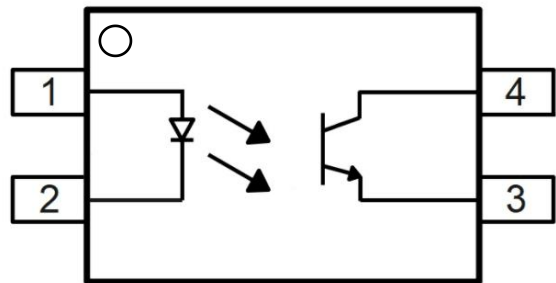
With the robust coplanar double mold structure, ICPL-851 series provide the most stable isolation feature.



ORDERING INFORMATION

Outline	Part Number	Package	Marking	Packing	Packing Size	Quantity
	ICPL-851-010E	DIP4	ICPL 851 /YYWW A	Tube	500mm	100
	ICPL-851-110E	DIP4-M		Tube	500mm	100
	ICPL-851-510E	DIP4-SL		Reel	13 "	1000

CONTENTS

Pin Configuration And Functions.3
Absolute Maximum Ratings.3
Electrical Optical Characteristics.4
Characteristic Curves.5
Test Circuits.7
Package Dimensions.8
Recommended Solder Mask10
Carrier Tape Specifications11
Ordering And Marking Information12
Reflow Information13
Temperature Profile Of Soldering.14
Disclaimer15

PIN CONFIGURATION AND FUNCTIONS

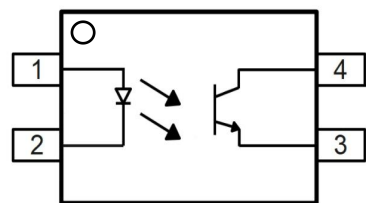
	Pin	Name
	1	Anode
	2	Cathode
	3	Emitter
	4	Collector

ABSOLUTE MAXIMUM RATINGS

Parameter	Symbol	Value	Unit	Note
INPUT				
Forward Current	I_F	60	mA	
Peak Forward Current	I_{FP}	1	A	1
Reverse Voltage	V_R	6	V	
Input Power Dissipation	P_I	100	mW	
OUTPUT				
Collector - Emitter Voltage	V_{CEO}	350	V	
Emitter - Collector Voltage	V_{ECO}	7	V	
Collector Current	I_C	50	mA	
Output Power Dissipation	P_O	150	mW	
COMMON				
Total Power Dissipation	P_{tot}	200	mW	
Isolation Voltage	V_{iso}	5000	V _{rms}	2
Operating Temperature	T_{opr}	-40~110	°C	
Storage Temperature	T_{stg}	-55~150	°C	
Soldering Temperature	T_{sol}	260	°C	

Note 1. 100µs pulse, 100Hz frequency

Note 2. AC For 1 Minute, R.H. = 40 ~ 60%

ELECTRICAL OPTICAL CHARACTERISTICS(T_a=25°C)

Parameter	Symbol	Min	Typ.	Max.	Unit	Test Condition	Note
INPUT							
Forward Voltage	V _F	-	1.24	1.4	V	I _F =10mA	
Reverse Current	I _R	-	-	10	μA	V _R =6V	
Input Capacitance	C _{in}	-	10	-	pF	V=0, f=1kHz	
OUTPUT							
Collector Dark Current	I _{CEO}	-	-	100	nA	V _{CE} =200V, I _F =0	
Collector-Emitter Breakdown Voltage	BV _{CEO}	350	-	-	V	I _C =0.1mA, I _F =0	
Emitter-Collector Breakdown Voltage	BV _{ECO}	7	-	-	V	I _E =0.1mA, I _F =0	
TRANSFER CHARACTERISTICS							
Current Transfer Ratio	CTR	50	-	600	%	I _F =5mA, V _{CE} =5V	
Collector-Emitter Saturation Voltage	V _{CE(sat)}	-	0.055	0.4	V	I _F =20mA, I _C =1mA	
Isolation Resistance	R _{ISO}	10 ¹²	10 ¹⁴	-	Ω	DC500V, 40 ~ 60% R.H.	
Floating Capacitance	C _{IO}	-	0.6	1	pF	V=0, f=1MHz	
Response Time (Rise)	t _r	-	3	18	μs	V _{CE} =2V, I _C =2mA	3
Response Time (Fall)	t _f	-	4	18	μs	R _L =100Ω	3
Cut-off Frequency	f _c	-	80	-	kHz	V _{CE} =2V, I _C =2mA R _L =100Ω, -3dB	4

Note 3. Fig.12&13

Note 4. Fig.14

CHARACTERISTIC CURVES

Fig.1 Forward Current vs. Ambient Temperature

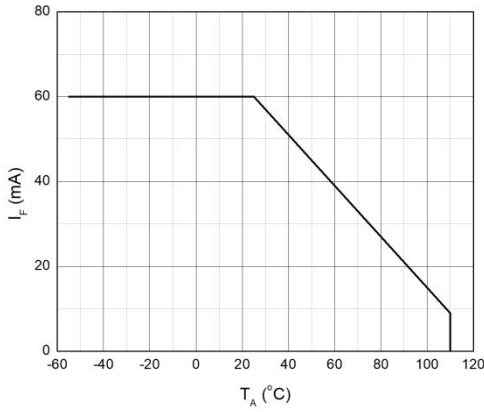

Fig.2 Collector Power Dissipation vs. Ambient Temperature

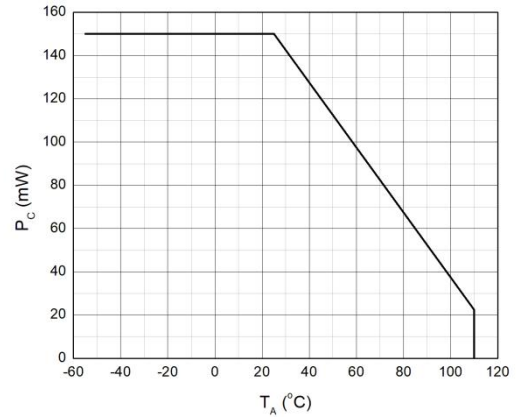

Fig.3 Forward Current vs. Forward Voltage

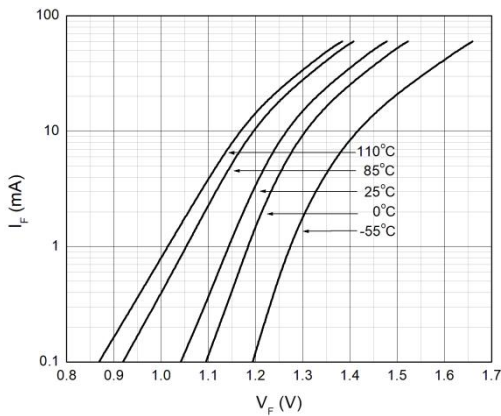

Fig.4 Collector Dark Current vs. Ambient Temperature

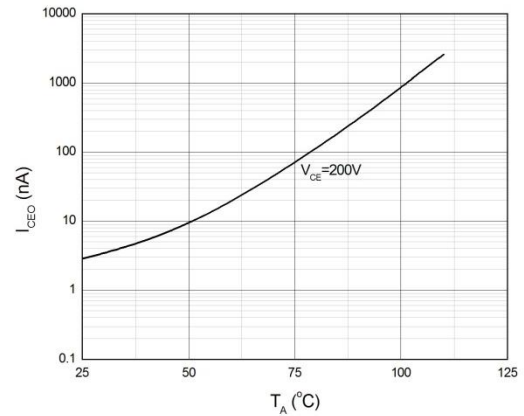

Fig.5 Collector Current vs. Collector-emitter Voltage

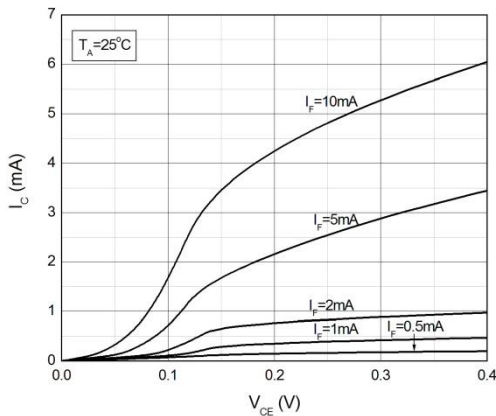

Fig.6 Collector Current vs. Collector-emitter Voltage

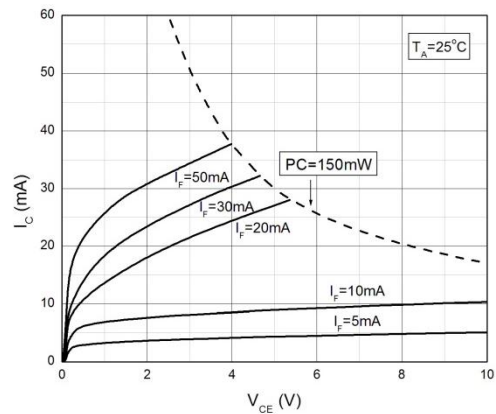

Fig.7 Normalized Current Transfer Ratio vs. Forward Current

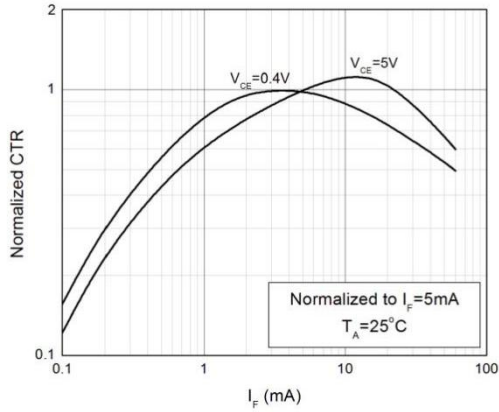

Fig.8 Normalized Current Transfer Ratio vs. Ambient Temperature

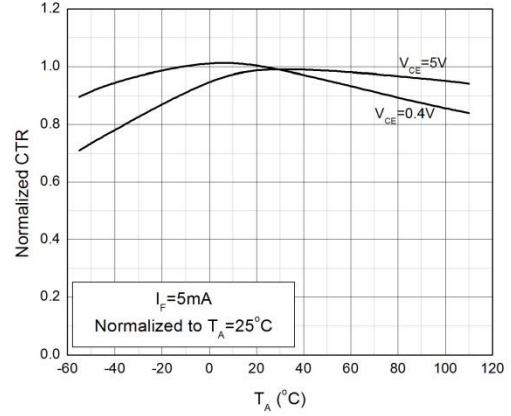

Fig.9 Collector-emitter Saturation Voltage vs. Ambient Temperature

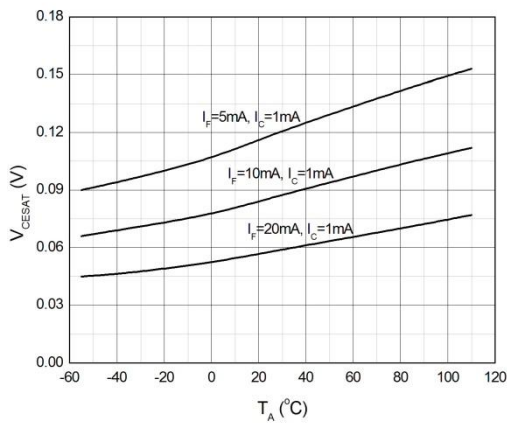

Fig.10 Switching Time vs. Load Resistance

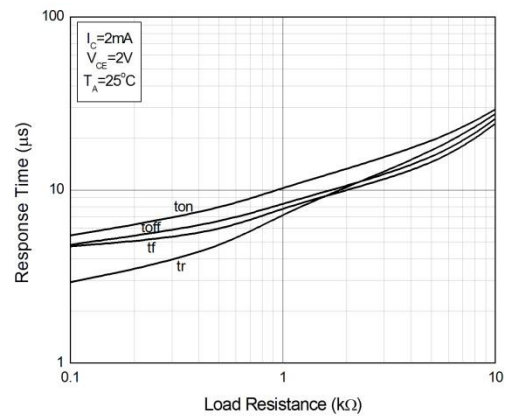
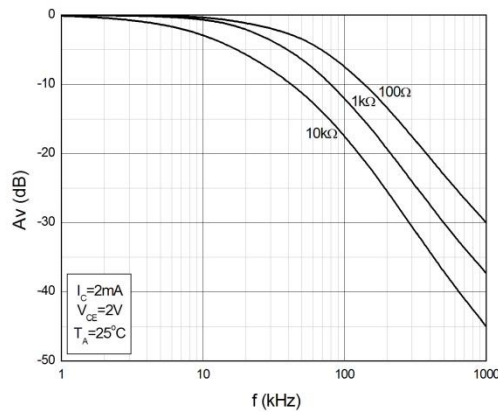
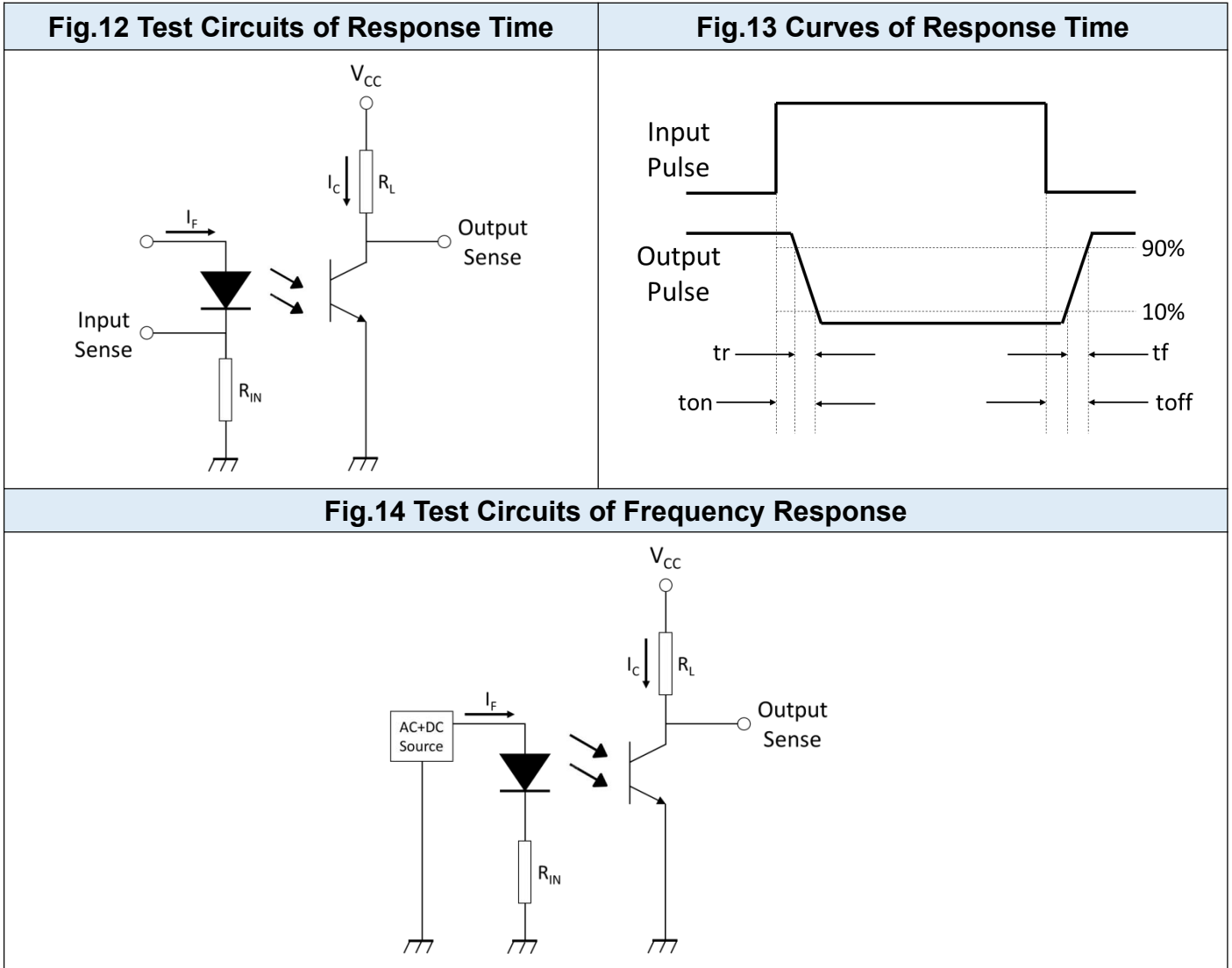

Fig.11 Frequency Response



TEST CIRCUITS



PACKAGE DIMENSIONS

Standard DIP – Through Hole (DIP Type)

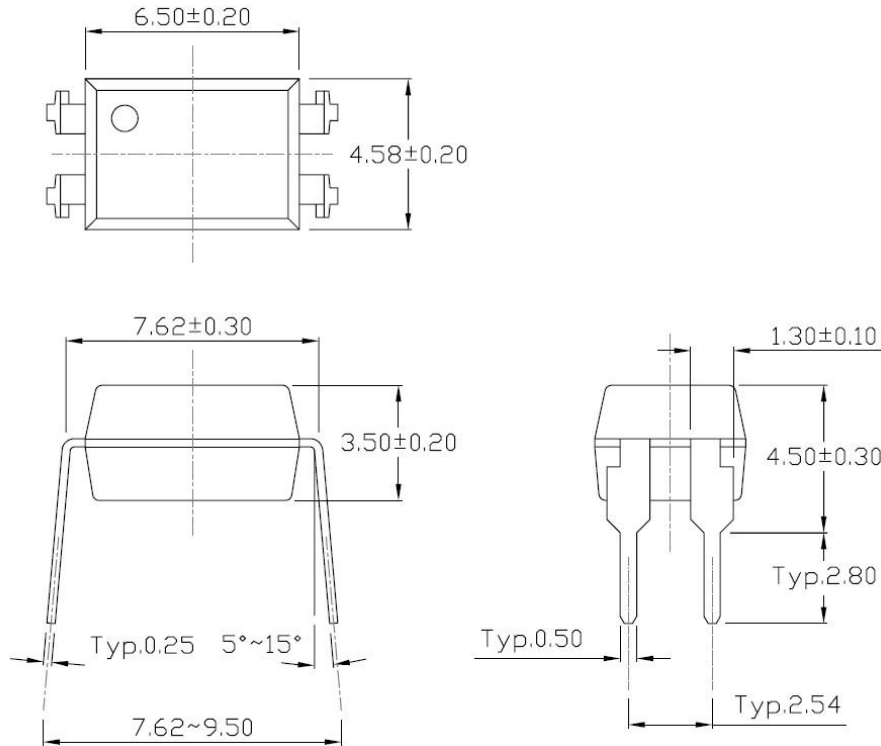

Gullwing (400mil) Lead Forming – Through Hole (M Type)

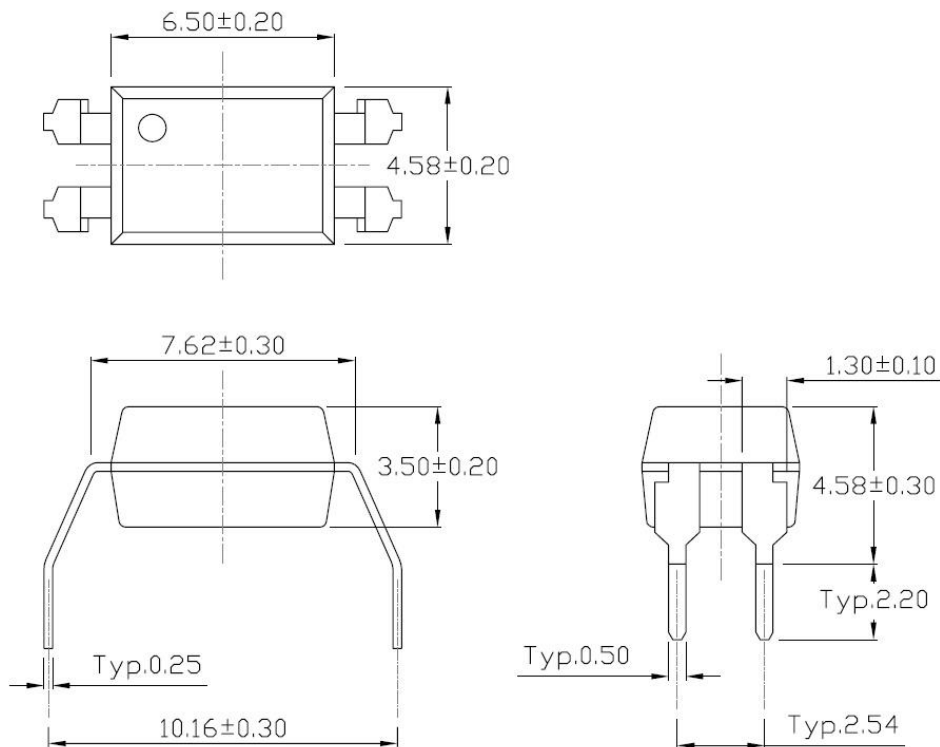

Surface Mount (Low Profile) Lead Forming (SL Type)

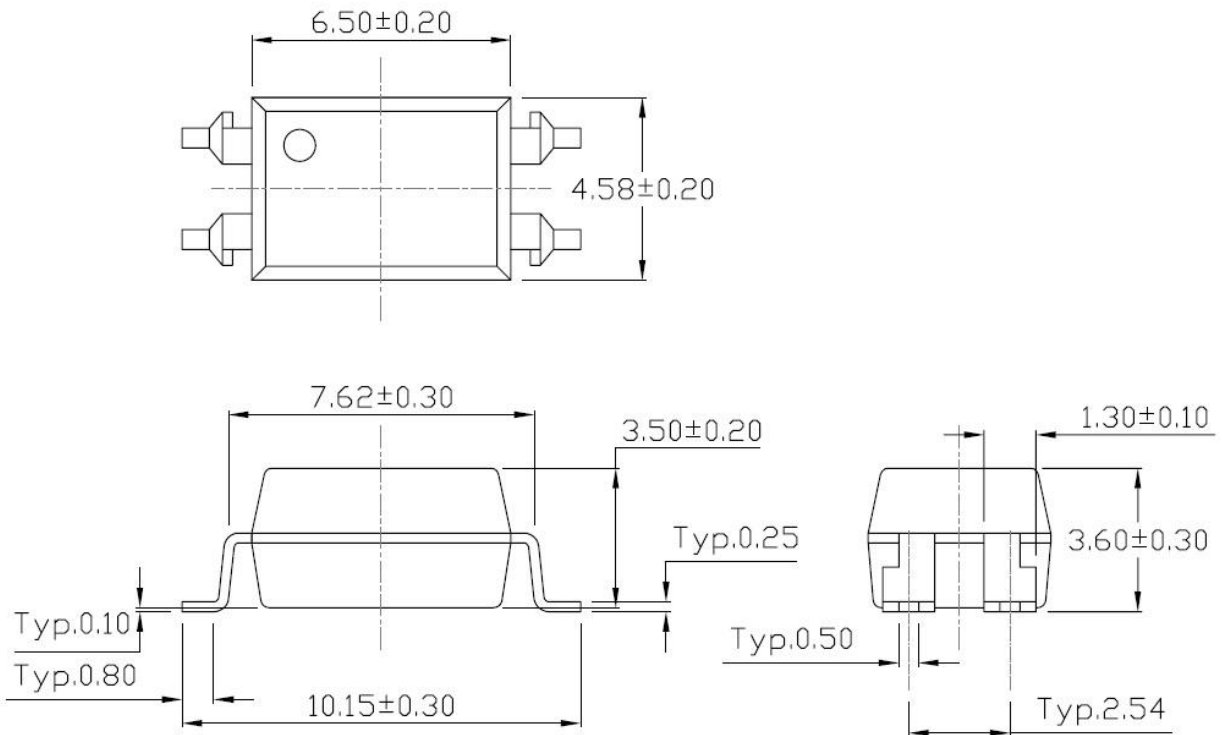

- **Dimensions in mm unless otherwise stated**

RECOMMENDED SOLDER MASK

Surface Mount (Low Profile) Lead Forming

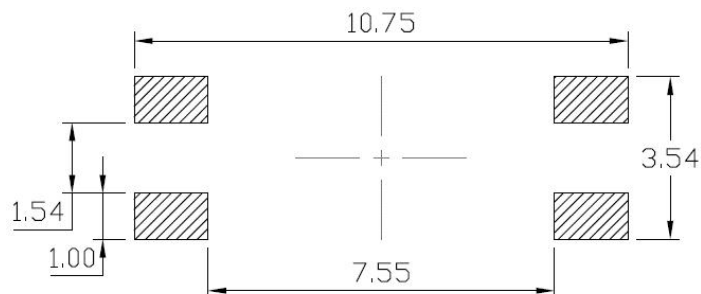

Surface Mount (Gullwing) Lead Forming

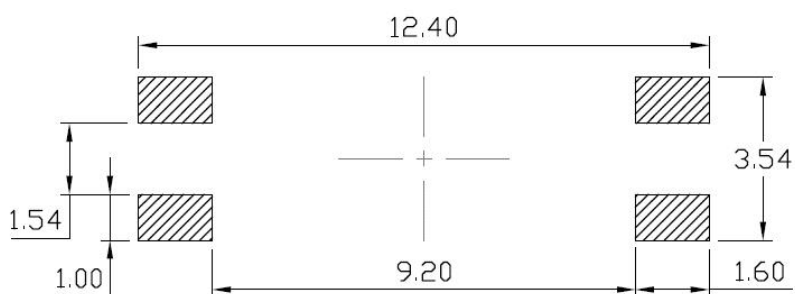

- Dimensions in mm unless otherwise stated

CARRIER TAPE SPECIFICATIONS

Option DIP-Standard & DIP-M

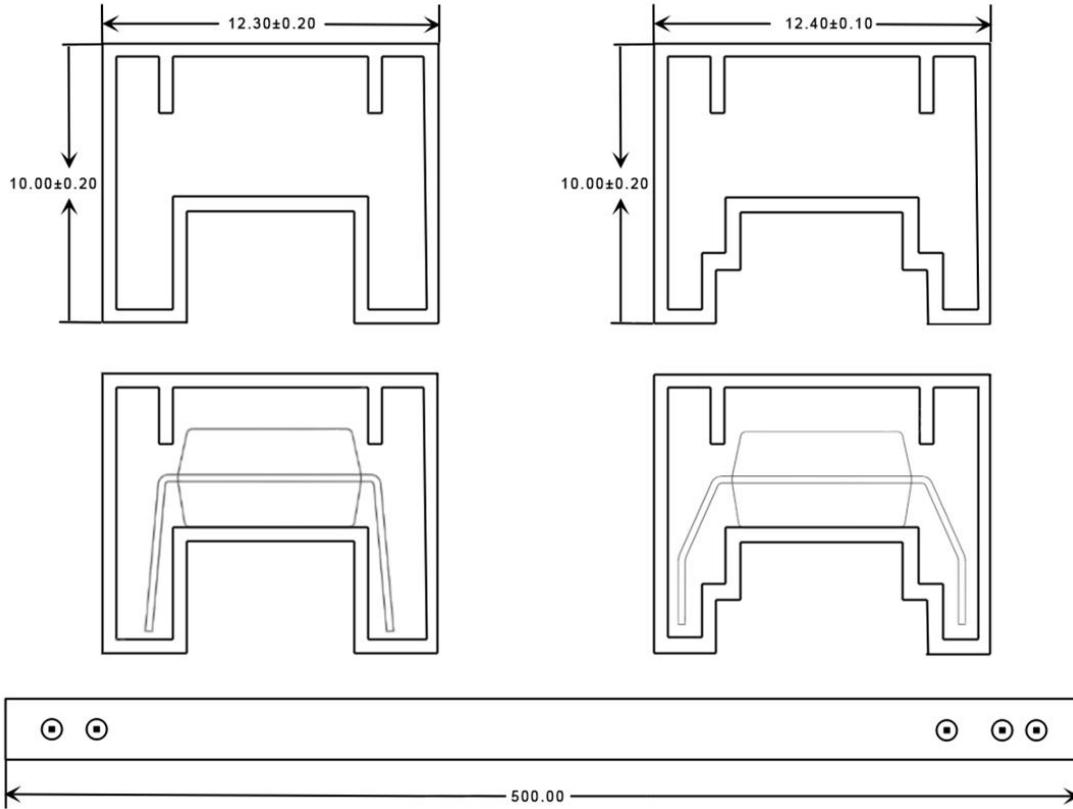

Option SM-SL

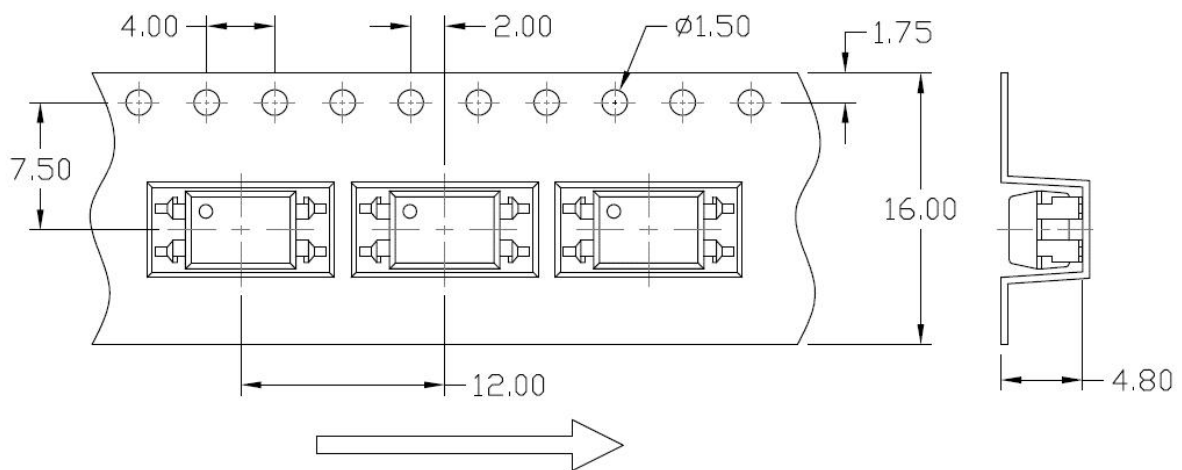

- Dimensions in mm unless otherwise stated

ORDERING AND MARKING INFORMATION

Marking Information	
	<p>ICPL : Company Abbr. 851 : Part Number / : ISOMICRON YY : Fiscal Year WW : Work Week A : Manufacturing Code</p>

Order Code	
<p>ICPL - 851 - 5 1 0 E</p>	
<p>Company Abbr. ←</p>	
<p>Part Number ←</p>	
<p>Lead Forming ←</p> <p>0: DIP-Standard 1: DIP-M 5: SM-SL</p>	
	<p>Halogen Free: E: Halogen-free, Lead-free Z: Halogen, Lead-free</p>
	<p>CTR Rank None</p>
	<p>Performance: 0: Normal 1: Enhanced 2: Industrial level 3: Auto level 4: Military level</p>

Packing Quantity			
Option	Quantity	Quantity – Inner box	Quantity – Outer box
DIP-Standard	100 Units/Tube	20 Tubes/Inner box	6 Inner box/Outer box = 12k Units
DIP-M	100 Units/Tube	20 Tubes/Inner box	6 Inner box/Outer box = 12k Units
SM-SL	1000 Units/Reel	2 Reels/Inner box	5 Inner box/Outer box = 10k Units

REFLOW INFORMATION

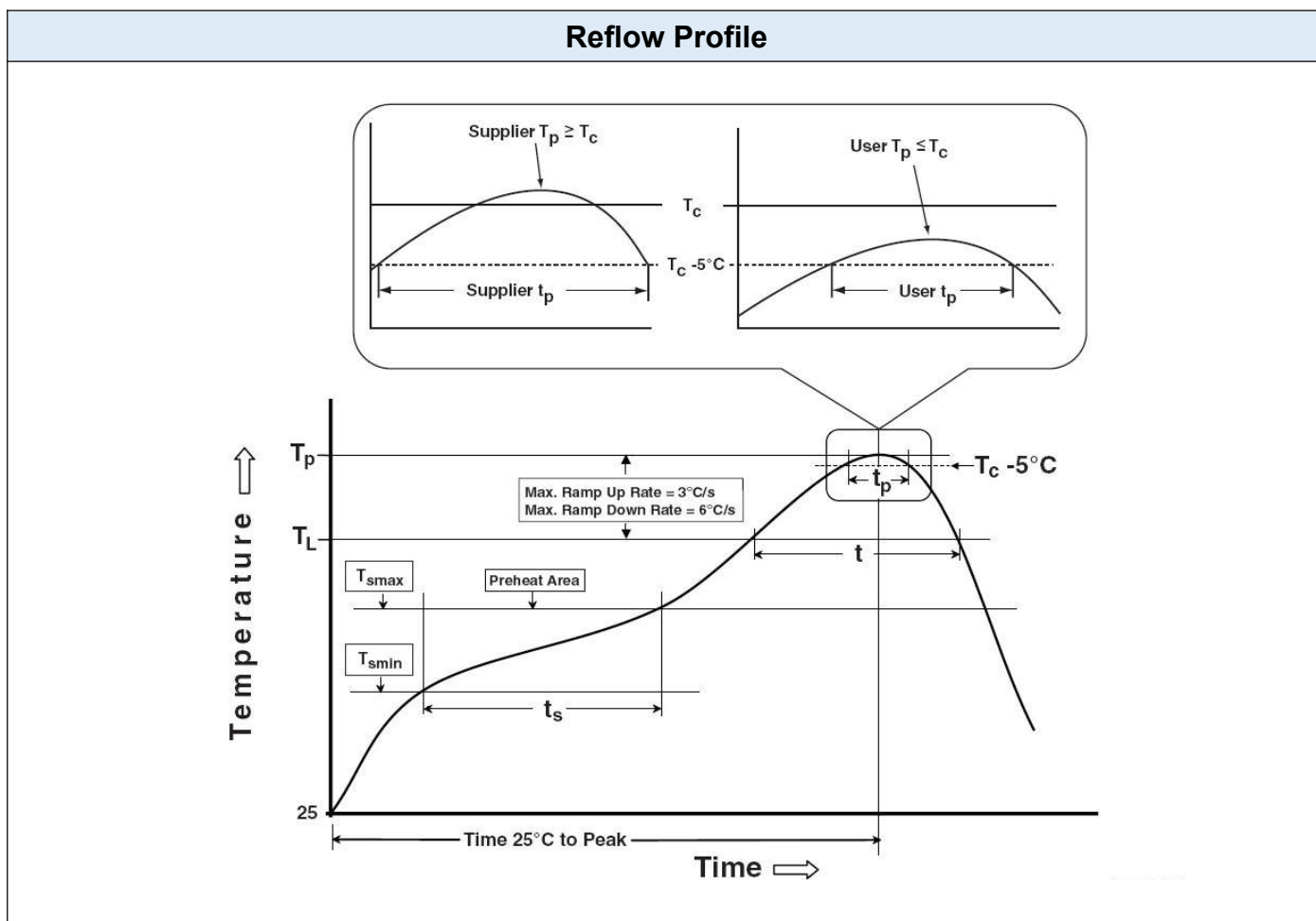

Profile Feature	Sn-Pb Assembly Profile	Pb-Free Assembly Profile
Temperature Min. (T _{smin})	100	150°C
Temperature Max. (T _{smax})	150	200°C
Time (t _s) from (T _{smin} to T _{smax})	60-120 seconds	60-120 seconds
Ramp-up Rate (t _L to t _P)	3°C/second max.	3°C/second max.
Liquidous Temperature (T _L)	183°C	217°C
Time (t _L) Maintained Above (T _L)	60 – 150 seconds	60 – 150 seconds
Peak Body Package Temperature	235°C +0°C / -5°C	260°C +0°C / -5°C
Time (t _P) within 5°C of 260°C	20 seconds	30 seconds
Ramp-down Rate (T _P to T _L)	6°C/second max	6°C/second max
Time 25°C to Peak Temperature	6 minutes max.	8 minutes max.

TEMPERATURE PROFILE OF SOLDERING

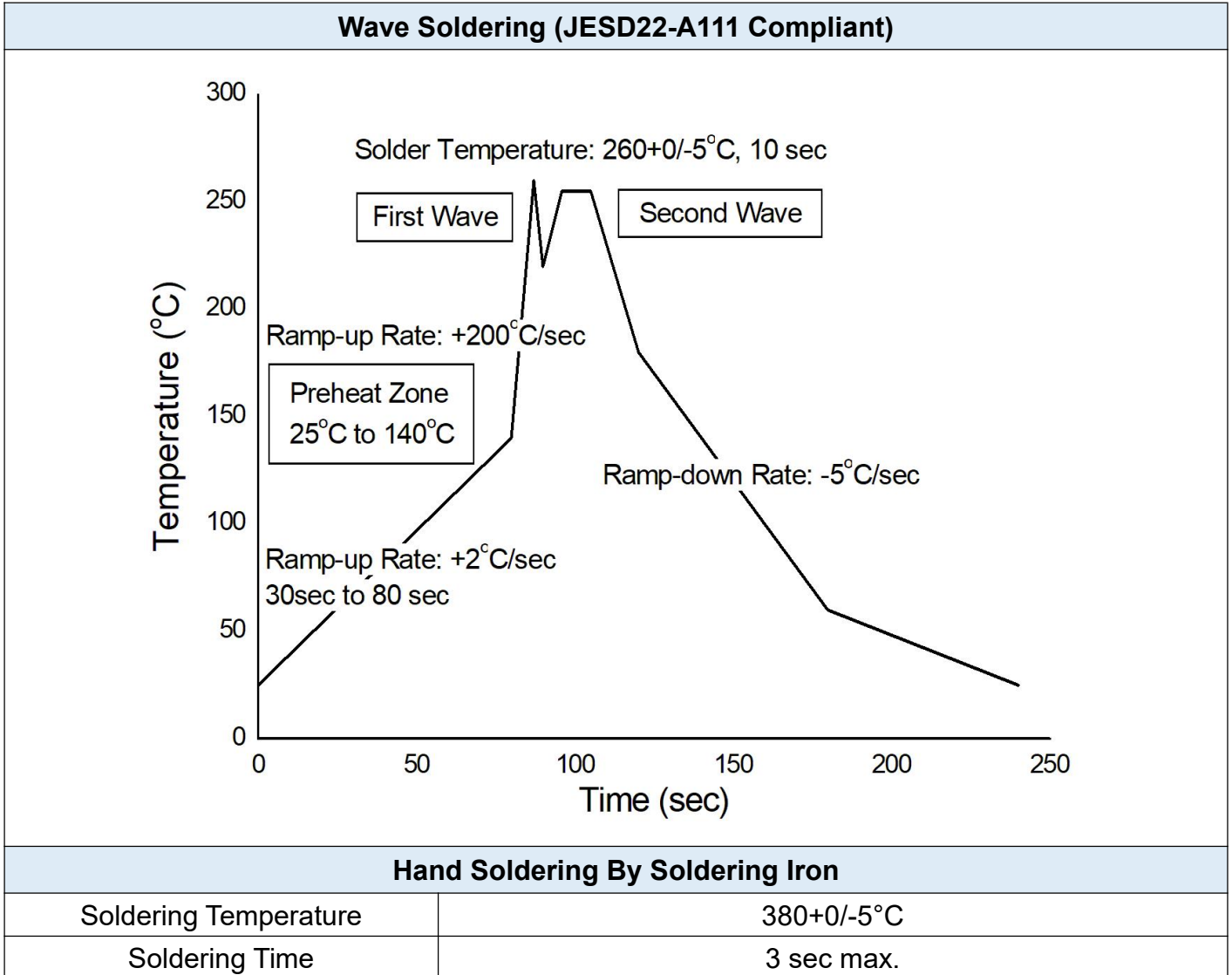

- One time soldering is recommended for all soldering method.
- Do not solder more than three times for IR reflow soldering.

DISCLAIMER

- ISOMICRON is continually improving the quality, reliability, function and design. ISOMICRON reserves the right to make changes without further notices.
- The characteristic curves shown in this datasheet are representing typical performance which are not guaranteed.
- ISOMICRON makes no warranty, representation or guarantee regarding the suitability of the products for any particular purpose or the continuing production of any product. To the maximum extent permitted by applicable law, ISOMICRON disclaims (a) any and all liability arising out of the application or use of any product, (b) any and all liability, including without limitation special, consequential or incidental damages, and (c) any and all implied warranties, including warranties of fitness for particular
- The products shown in this publication are designed for the general use in electronic applications such as office automation, equipment, communications devices, audio/visual equipment, electrical application and instrumentation purpose, non-infringement and merchantability.
- This product is not intended to be used for military, aircraft, automotive, medical, life sustaining or lifesaving applications or any other application which can result in human injury or death.
- Please contact ISOMICRON sales agent for special application request.
- Immerge unit's body in solder paste is not recommended.
- Parameters provided in datasheets may vary in different applications and performance may vary over time. All operating parameters, including typical parameters, must be validated in each customer application by the customer's technical experts. Product specifications do not expand or otherwise modify ISOMICRON's terms and conditions of purchase, including but not limited to the warranty expressed therein.
- Discoloration might be occurred on the package surface after soldering, reflow or long-time use. It neither impacts the performance nor reliability.